

Gamers Digital[®] Get started!

1



UNFOLD headphone jack by lifting rubber tab and gentle rotating the jack.

2



CENTER the keyboard between the grips and slide the keyboard in place.

3



Then,

with the controller turned on, hold the pairing key for **3** seconds until you see the pairing LED turn on.

4

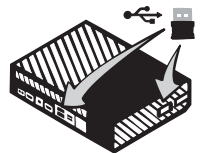

With the Xbox One turned **ON**, insert the USB receiver into a Xbox USB port. It will pair in 5-10 seconds, and pairing LED will turn off.

TROUBLESHOOTING Please be sure your controller is fully charged or has fresh batteries to avoid performance issues due to low power like repeating or delays in characters. For more help, including returns, please contact us at: support@gamersdigital.com

Rev 2.0 August 2019

Gamers Digital[®] Get started!

1



UNFOLD headphone jack by lifting rubber tab and gentle rotating the jack.

2



CENTER the keyboard between the grips and slide the keyboard in place.

3



Then,

with the controller turned on, hold the pairing key for **3** seconds until you see the pairing LED turn on.

4



With the Xbox One turned **ON**, insert the USB receiver into a Xbox USB port. It will pair in 5-10 seconds, and pairing LED will turn off.

TROUBLESHOOTING Please be sure your controller is fully charged or has fresh batteries to avoid performance issues due to low power like repeating or delays in characters. For more help, including returns, please contact us at: support@gamersdigital.com

Rev 2.0 August 2019