



Quick Start Guide

WIRELESS BACKLIT KEYBOARD
PATENT NO: ZL201530514300.7

Product Introduction

Designed for all Xbox One controllers. Fits perfectly without affecting the use of headphones. It can input text and symbols conveniently and quickly.

Players can group chat with this keyboard comfortably. It is easy to connect and take out of the controller and can also combine with any version of Xbox One original controller: useful with in-game text messaging, instant messaging, and other text entry.

The keyboard surface is made of environmentally safe silicone and uses tactical feedback type keys to make it smooth and comfortable to your touch.

Functional Buttons

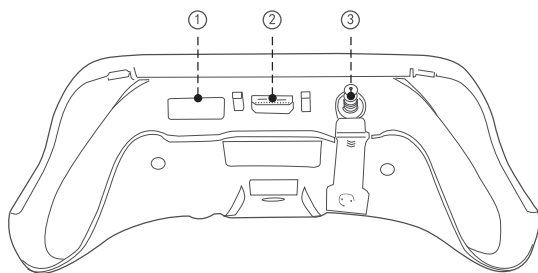

1. Storage hole for 2.4G receiver 3. 3.5mm audio jack
2. Xbox One original earphone jack

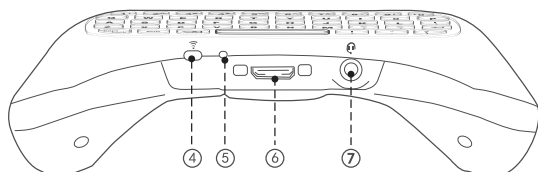

4. Pairing key 7. 3.5mm female audio jack
5. Pairing indicator
6. Xbox One original earphone jack

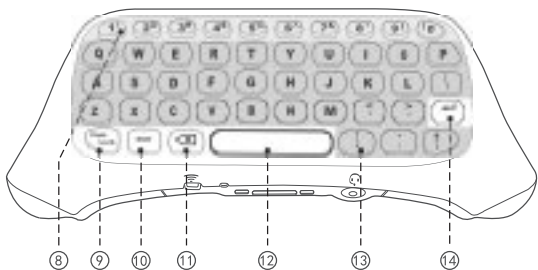

8. 0-9 (number keys) 12. SPACE key
9. CAPS LOCK key 13. 26 English letters and common symbol keys
10. SHIFT key 14. ENTER key
11. BACK SPACE key

Product Maintenance and Precautions

- The keyboard can be used only when the host is paired successfully to the controller keyboard.
- Do not knock on or beat the product strongly.
- Liquid or small metal are not allowed to come into the product.
- Do not use and store the product in a hot or humid environment.

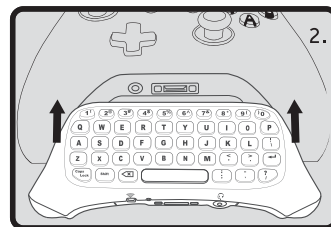
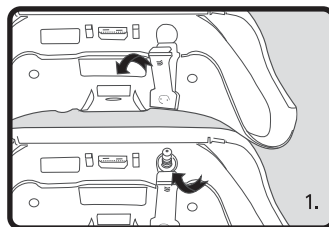

- Remove the 2.4G USB receiver from the storage slot on the back of the controller (1). Fold out the 3.5mm audio jack, if your controller has the matching connector.
- Rest the upper corner edges on the surface of the controller. Then push the keyboard slowly forward until securely connected.

Press the "⌫" button on the controller (the "⌫" with light up). If you have the backlight keyboard, the keyboard will also light up.

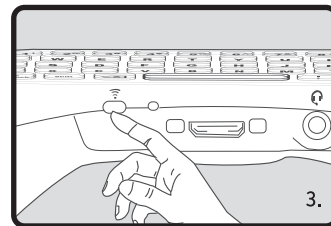
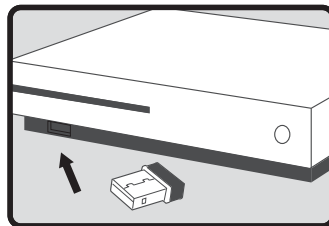

- After connection with the Xbox One on, insert the 2.4G receiver (included) into any USB port of the Xbox One (S) console (front USB port recommended). Then, enter the pairing key on the back of the Xbox One (S) keyboard within 15 seconds. It will be automatically paired while the blue indicator is flashing. (Note: when pairing, the distance between keyboard and receiver must be within **6 inches**. If pairing fails, do above steps again.)

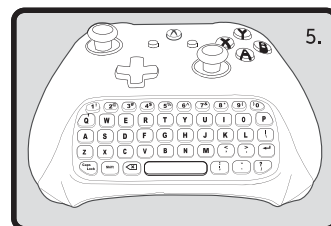
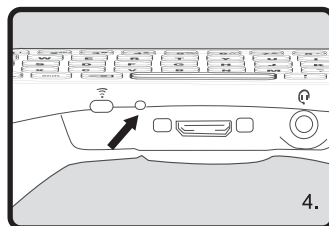

- After pairing the blue LED will go off and the keyboard is ready to use.
- Pair only once between the Xbox One (S) keyboard with 2.4G receiver. Open the console to awake the controller automatically for further use.

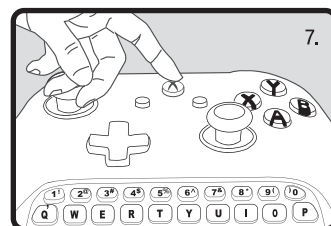
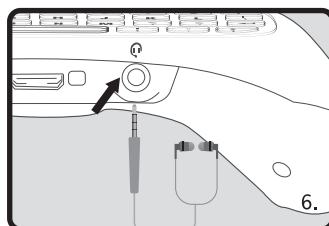

- The Xbox One (S) headset jack of this product is compatible with the Xbox One (S) original headset and has the same effect as connecting with the controller. Controller must have 3.5mm input for keyboard to use 3.5mm output.
- This product is in sleeping mode while the Xbox One (S) controller sleeps. Please press "⌫" button to awake keyboard and controller.

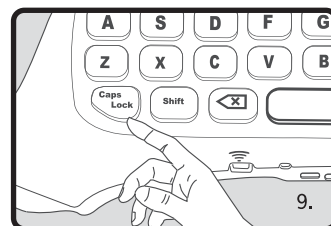
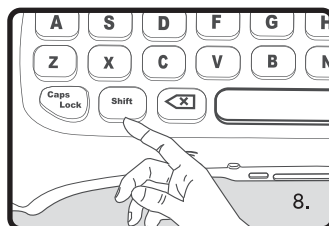

- Hold down the "SHIFT" key and select the key you need. Then, you can type the corresponding symbol. (Manually hold down the SHIFT key, and then press the SPACE key to force the keyboard backlight on or off.)
- Press the CAPS LOCK key to Lock the capital input, and press this key again to change into lowercase input.